

# 7130

*Electric Strike for MS<sup>®</sup>1850 replacement - Aluminium Doors*



## Function

For remote access control of any narrow stile, aluminium door equipped with Adams Rite 4700 series (or similar) deadlatch. Electrical actuation unlocks the strike jaw, releasing the latchbolt so the door can be opened without operating the latch itself. The compact mechanism fits into an aluminium jamb section as shallow as 44.45mm whilst still retaining the existing face cutout detail (faceplate and subcover) of the 7830 Series.

The 7130 Series strikes have a large flat faceplate to cover the strike opening when converting from an MS<sup>®</sup> pivoted-bolt deadlock to a deadlatch, and are designed for mounting in the frame of single action single leaf doors - for single action pairs of doors with radius nosed faceplate, specify the 7131 Series.

**Note:** For maximum security specify an MS<sup>®</sup> Deadlock in conjunction with the electric strike/latch combination.

## Specifications

Current Draw:	12vAC=1.48A, 12vDC=0.332A 24vAC=0.74A, 24vDC=0.19A (nominal). DC intermittent and continuous units are silent, AC intermittent units "buzz" on operation.
Voltage Tolerance:	±10%.
Powered By:	Internal solenoid.
Monitoring:	(Optional) Single: Latch only, Double: Latch & solenoid.
Duty:	Fail-safe or fail-secure (convertible without additional parts). DC power supply required for fail-safe operation.
Jaw Strength:	907kg (2000lbs).
Case:	85.6mm x 28.6mm x 41.6mm. Zinc aluminium alloy.
Mechanism:	Stainless steel internal blocking mechanism.
Strike Opening:	36.5mm x 15.9mm x 12.7mm. Stainless steel bolt retainer jaw.
Door Gap:	Minimum 3mm (1/8"), operational door gap 3-5mm.
Faceplate:	Aluminium. 174.5mm x 31.8mm. Flat.
Finishes:	See ordering codes.
Subcover:	Basic subcover lip will suit a 44.45mm (1 3/4") thick door that closes flush with jamb edge. For extended bolt-on subcovers see ordering codes (7130 only).
Standards:	ANSI/BHMA 156.5 Grade 1. UL Listed for burglary resistance.

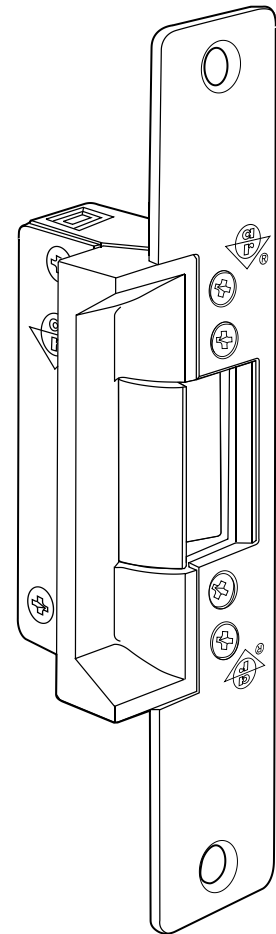

## Dimensions

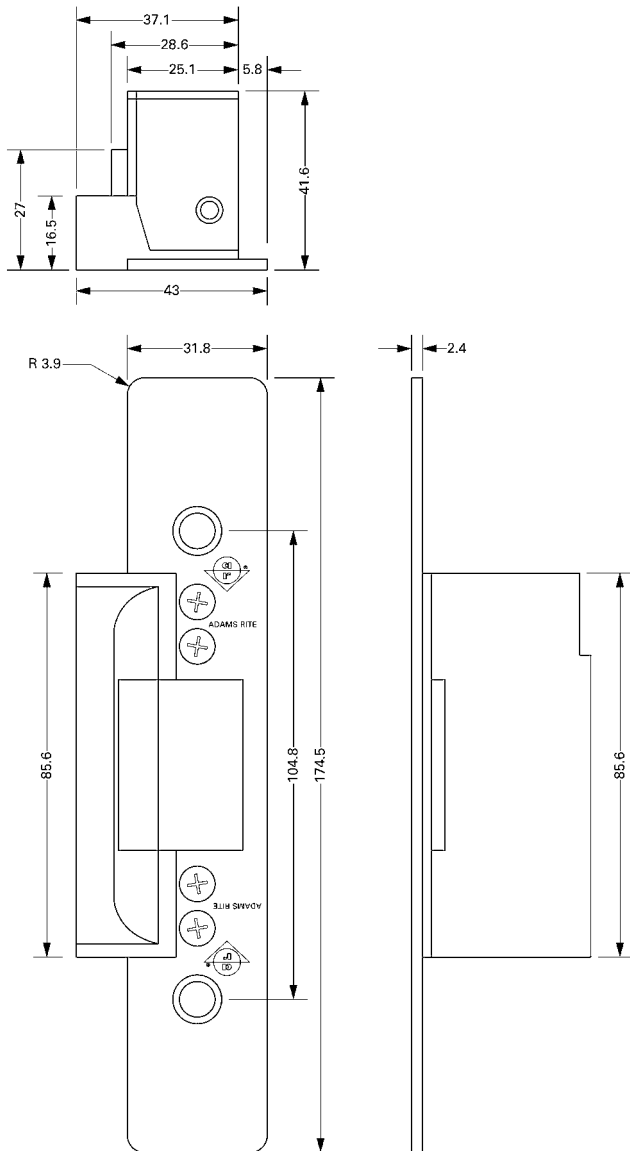

## Ordering Codes Matrix

**7130 - 3 1 0 - 628 - 1**

- Model Number**
  - 7130 Flat
  - 7131 Radius
- Voltage**
  - 3 12 volt
  - 5 24 volt
- Current and Duty**
  - 1 DC Continuous or intermittent
  - 4 AC Intermittent (fail-secure only)
- Features**
  - 0 Standard/Fail-Secure
  - 5 Standard/Fail-Safe
  - 7 Monitored/Fail-Safe
  - 9 Monitored/Fail-Secure
- Finish**
  - 628 Satin Aluminium
  - 605 Bright Brass
  - 612 Satin Bronze
  - 613 Oil Bronze
  - 313 Bronze
  - 335 Black
- Options**
  - 1 Single Monitoring (Latch only)
  - 2 Double Monitoring (Latch and Solenoid)

### Subcover Extension Codes (order separately)

Order Code	Dimension*	Order Code	Dimension*
91-0171-01	38.1mm (1.50")	91-0171-08	60.5mm (2.38")
91-0171-02	41.4mm (1.63")	91-0171-09	63.5mm (2.50")
91-0171-03	44.5mm (1.75")	91-0171-10	66.8mm (2.63")
91-0171-04	47.8mm (1.88")	91-0171-11	69.9mm (2.75")
91-0171-05	50.8mm (2.00")	91-0171-12	73.2mm (2.88")
91-0171-06	54.1mm (2.13")	91-0171-13	76.2mm (3.00")
91-0171-07	57.2mm (2.25")		

\*Dimension from door centreline to jamb edge. Not available on 7131.

## Related Hardware

RiteKey Keypad (p54) ~ Push-to-Exit Button (p56) ~ Power Supply Unit (p58) ~ 4710 Deadlatch ~ 4750 Deadlatch